

I, MICHAEL STEPHEN SMITH, MIPENZ CPENG HEREBY BELIEVE ON ALL REASONABLE GROUNDS THAT THE LOCATIONS OF KERBS, CHANNELS, STREET LIGHTS AND FOOTPATHS ARE ACCURATELY PLOTTED IN RELATION TO BOUNDARIES AND IS CORRECT AS THIS INFORMATION HAS BEEN PROVIDED BY THE CONTRACTOR OF THE WORKS - KERRY DINES LTD.

-----  
 MICHAEL STEPHEN SMITH                      DATE  
 MIPENZ CPENG

**STREET LIGHT DETAILS**  
 TYPE A - 7.5m VICPOLE 125mm SQUARE SERIES COLUMN HOT DIPPED GALV, TWO PACT BLACK PAINT FINISH. CREE EDGE SQUARE SERIES XAL 1304C-UT LED LIGHT FIXTURE. 40 WATT LED (525MA DRIVER), TYPE 3M OPTICS

STREET LIGHT COORDINATES			
	mN	mE	
SL81	758967.85	421918.61	TYPE A
SL82	758921.27	421921.11	TYPE A
SL83	758865.04	421927.85	TYPE A
SL84	758836.05	421971.30	TYPE A
SL85	758816.04	422011.17	TYPE A
SL86	758929.81	421757.89	TYPE A
SL87	758932.90	421780.24	TYPE A
SL88	758887.96	421801.41	TYPE A
SL89	758836.30	421824.67	TYPE A
SL90	758799.79	421802.01	TYPE A
SL91	758794.87	421741.12	TYPE A
SL92	758808.47	421688.91	TYPE A
SL93	758815.58	421630.84	TYPE A

**NOTES**

- ALL COORDINATES ARE IN METRES AND IN TERMS OF GEODETIC 2000 MT. EDEN
- ALL LEVELS ARE IN METRES AND IN TERMS OF THE LANDS AND SURVEY DATUM (MEAN SEA LEVEL) AUCKLAND 1946

**LEGEND**

	STD. KERB		EDGE OF SEAL
	KERB & NIB		TRANSITION TO
	MOUNTABLE KERB		EXISTING
	CHANNEL		STREET LIGHTS
	FOOTPATH		DRIVEWAY
	CHIPSEAL ONLY		

REV	REVISION DETAILS	BY	DATE

PLOTTED: DATE: 02-20  
 RJP  
 DRAWN: DATE: 02-20  
 RJP  
 APPROVED: DATE: 02-20  
 MSS

THIS DRAWING AND DESIGN REMAINS THE PROPERTY OF, AND MAY NOT BE REPRODUCED OR ALTERED, WITHOUT THE WRITTEN PERMISSION OF CIVILPLAN CONSULTANTS LIMITED. NO LIABILITY SHALL BE ACCEPTED FOR UNAUTHORISED USE OF THIS DRAWING.



PROJECT TITLE:  
 DFH JOINT VENTURE  
 HITCHEN STAGE 11,12 & 14 SUBDIVISIONS  
 POKENO

SHEET TITLE:  
 AS BUILT ROADING

ISSUE STATUS: **AS BUILT**  
 SCALE: (A1/A3) 0 20 40 60 80 100m  
 1:750 / 1:1500  
 DRAWING NUMBER: 136701-11-AB300 REV: A

Filepath: P:\APPDATA\LOCAL\AUTODESK\C3D 2020\ENU\TEMPLATE C:\DATA\POKENO\HITCHEN\STAGE 11\AS BUILT\136701-11-AB300.DWG

**NOTES**

1. ALL COORDINATES ARE IN METRES AND IN TERMS OF GEODETIC 2000 MT. EDEN
2. ALL LEVELS ARE IN METRES AND IN TERMS OF THE LANDS AND SURVEY DATUM (MEAN SEA LEVEL) AUCKLAND 1946
3. ALL LOT CONNECTIONS ARE 100NB PVC UNLESS SHOWN OTHERWISE.
4. MANHOLE INVERT LEVELS ARE LISTED CLOCKWISE FROM THE OUTLET PIPE.
5. ALL MANHOLES ARE 1050NB WITH STANDARD DUTY LIDS AND COVERS UNLESS SHOWN OTHERWISE.  
ALL STORMWATER PIPES 225NB AND OVER ARE RCRRJ CLASS 2 UNLESS SHOWN OTHERWISE EXCEPT FOR CATCHPIT LEADS WHICH ARE ALL CLASS 4. ALL CATCHPIT LEADS ARE 225NB UNLESS SHOWN OTHERWISE.
6. ALL CONCRETE PIPES AND STRUCTURES ARE MANUFACTURED BY HYNDS PIPES. ALL PLASTIC PIPES ARE MANUFACTURED BY MARLEY.

I, MICHAEL STEPHEN SMITH, MIPENZ CPENG HEREBY BELIEVE ON ALL REASONABLE GROUNDS THAT THE PIPE SIZES, FITTINGS, POSITIONS, COORDINATES AND LEVELS SHOWN ARE ACCURATELY PLOTTED IN RELATION TO BOUNDARIES AND IS CORRECT AS THIS INFORMATION HAS BEEN PROVIDED BY THE CONTRACTOR OF THE WORKS - KERRY DINES LTD.

-----  
 MICHAEL STEPHEN SMITH      DATE  
 MIPENZ CPENG

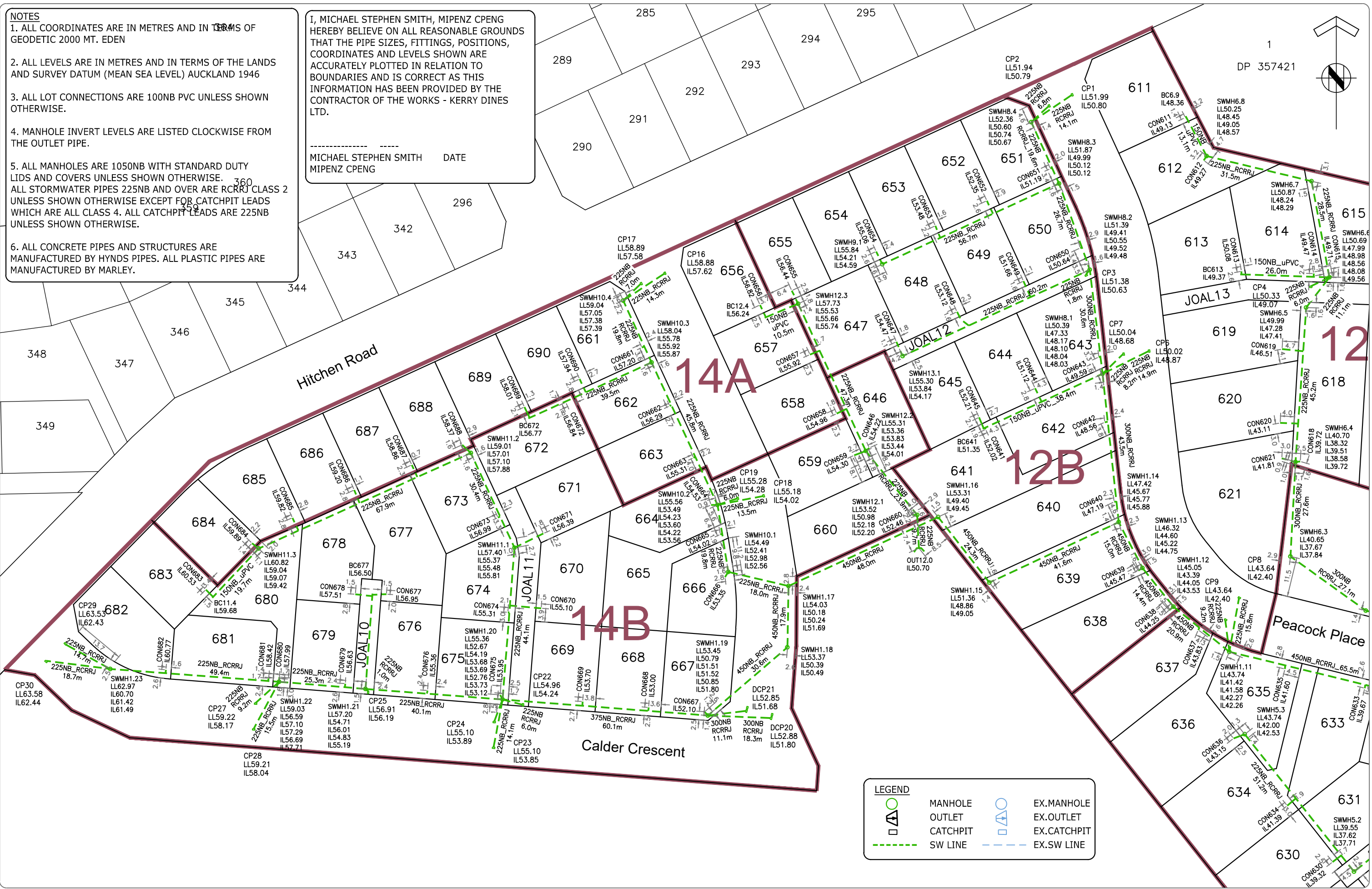

ISSUED FOR 224C	RJP	02-20
REVISION DETAILS	BY	DATE

DATE:	02-20
DATE:	02-20
DATE:	02-20

THIS DRAWING AND DESIGN REMAINS THE PROPERTY OF, AND MAY NOT BE REPRODUCED OR ALTERED, WITHOUT THE WRITTEN PERMISSION OF CIVILPLAN CONSULTANTS LIMITED. NO LIABILITY SHALL BE ACCEPTED FOR UNAUTHORISED USE OF THIS DRAWING.

**CIVILPLAN**  
 CONSULTANTS

Level 3 AMI Building, 15 Osterley Way, Manukau City. Phone: 2222445

PROJECT TITLE:  
**DFH JOINT VENTURE  
 HITCHEN STAGES 11,12,14 SUBDIVISION  
 POKENO**

SHEET TITLE:  
**AS BUILT  
 STORMWATER DRAINAGE  
 SHEET 1**

ISSUE STATUS:  
**AS BUILT**

SCALE: (A1/A3)  
 1:500 / 1:1000

DRAWING NUMBER: **136701-11-AB400** REV: **A**

Filepath: P:\APPDATA\LOCAL\AUTODESK\C3D 2020\ENU\TEMPLATE C:\DATA\POKENO\HITCHEN\STAGE 11\AS BUILT\136701-11-AB400.DWG

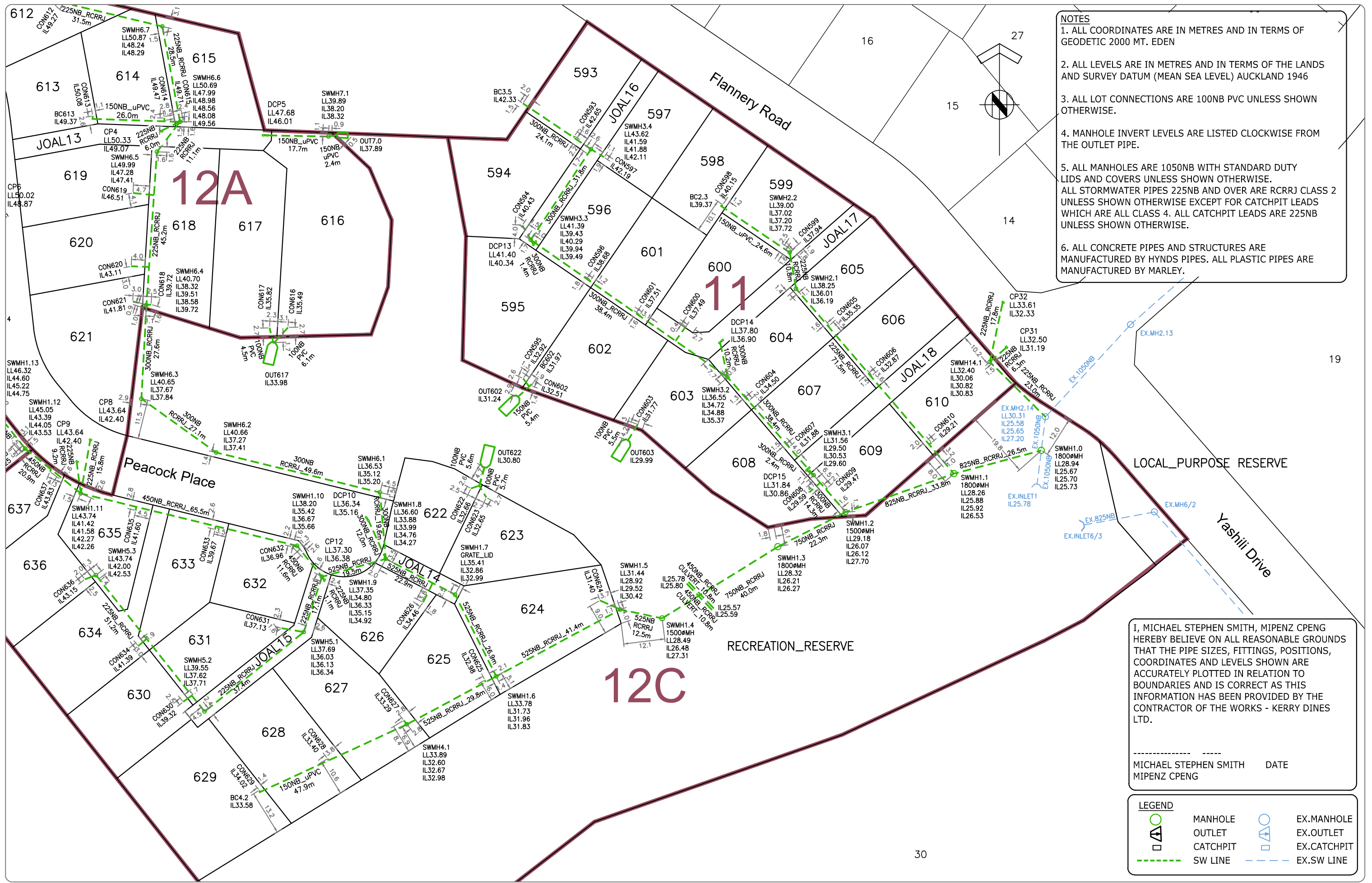

- NOTES**
1. ALL COORDINATES ARE IN METRES AND IN TERMS OF GEODETIC 2000 MT. EDEN
  2. ALL LEVELS ARE IN METRES AND IN TERMS OF THE LANDS AND SURVEY DATUM (MEAN SEA LEVEL) AUCKLAND 1946
  3. ALL LOT CONNECTIONS ARE 100NB PVC UNLESS SHOWN OTHERWISE.
  4. MANHOLE INVERT LEVELS ARE LISTED CLOCKWISE FROM THE OUTLET PIPE.
  5. ALL MANHOLES ARE 1050NB WITH STANDARD DUTY LIDS AND COVERS UNLESS SHOWN OTHERWISE. ALL STORMWATER PIPES 225NB AND OVER ARE RCRRJ CLASS 2 UNLESS SHOWN OTHERWISE EXCEPT FOR CATCHPIT LEADS WHICH ARE ALL CLASS 4. ALL CATCHPIT LEADS ARE 225NB UNLESS SHOWN OTHERWISE.
  6. ALL CONCRETE PIPES AND STRUCTURES ARE MANUFACTURED BY HYNDS PIPES. ALL PLASTIC PIPES ARE MANUFACTURED BY MARLEY.

I, MICHAEL STEPHEN SMITH, MIPENZ CPENG HEREBY BELIEVE ON ALL REASONABLE GROUNDS THAT THE PIPE SIZES, FITTINGS, POSITIONS, COORDINATES AND LEVELS SHOWN ARE ACCURATELY PLOTTED IN RELATION TO BOUNDARIES AND IS CORRECT AS THIS INFORMATION HAS BEEN PROVIDED BY THE CONTRACTOR OF THE WORKS - KERRY DINES LTD.

\_\_\_\_\_  
 MICHAEL STEPHEN SMITH      DATE  
 MIPENZ CPENG

**LEGEND**

	MANHOLE		EX.MANHOLE
	OUTLET		EX.OUTLET
	CATCHPIT		EX.CATCHPIT
	SW LINE		EX.SW LINE

ISSUED FOR 224C	RJP	02-20
REVISION DETAILS	BY	DATE

PLOTTED:	DATE:	THIS DRAWING AND DESIGN REMAINS THE PROPERTY OF, AND MAY NOT BE REPRODUCED OR ALTERED, WITHOUT THE WRITTEN PERMISSION OF CIVILPLAN CONSULTANTS LIMITED. NO LIABILITY SHALL BE ACCEPTED FOR UNAUTHORISED USE OF THIS DRAWING.
RJP	02-20	
DRAWN:	DATE:	
RJP	02-20	
APPROVED:	DATE:	
MSS	02-20	

**CIVILPLAN**  
 CONSULTANTS

Level 3 AMI Building, 15 Osterley Way, Manukau City. Phone: 2222445

PROJECT TITLE:  
 DFH JOINT VENTURE  
 HITCHEN STAGES 11,12,14 SUBDIVISION  
 POKENO

SHEET TITLE:  
 AS BUILT  
 STORMWATER DRAINAGE  
 SHEET 2

ISSUE STATUS: **AS BUILT**

SCALE: (A1/A3)  
 1:500 / 1:1000

DRAWING NUMBER: **136701-11-AB401**      REV: **A**

Filepath: P:\APPDATA\LOCAL\AUTODESK\C3D 2020\ENU\TEMPLATE C:\DATA\POKENO\HITCHEN\STAGE 11\AS BUILT\136701-11-AB400.DWG

- NOTES**
1. ALL COORDINATES ARE IN METRES AND IN TERMS OF GEODETIC 2000 MT. EDEN
  2. ALL LEVELS ARE IN METRES AND IN TERMS OF THE LANDS AND SURVEY DATUM (MEAN SEA LEVEL) AUCKLAND 1946
  3. ALL LOT CONNECTIONS ARE 100NB PVC UNLESS SHOWN OTHERWISE.
  4. MANHOLE INVERT LEVELS ARE LISTED CLOCKWISE FROM THE OUTLET PIPE.
  5. ALL MANHOLES ARE 1050NB WITH STANDARD DUTY LIDS AND COVERS UNLESS SHOWN OTHERWISE.
  6. ALL PIPES ARE MANUFACTURED BY MARLEY AND MANHOLES BY HYNDS PIPES.

I, MICHAEL STEPHEN SMITH, MIPENZ CPENG HEREBY BELIEVE ON ALL REASONABLE GROUNDS THAT THE PIPE SIZES, FITTINGS, POSITIONS, COORDINATES AND LEVELS SHOWN ARE ACCURATELY PLOTTED IN RELATION TO BOUNDARIES AND IS CORRECT AS THIS INFORMATION HAS BEEN PROVIDED BY THE CONTRACTOR OF THE WORKS - KERRY DINES LTD.

-----  
 MICHAEL STEPHEN SMITH      DATE  
 MIPENZ CPENG

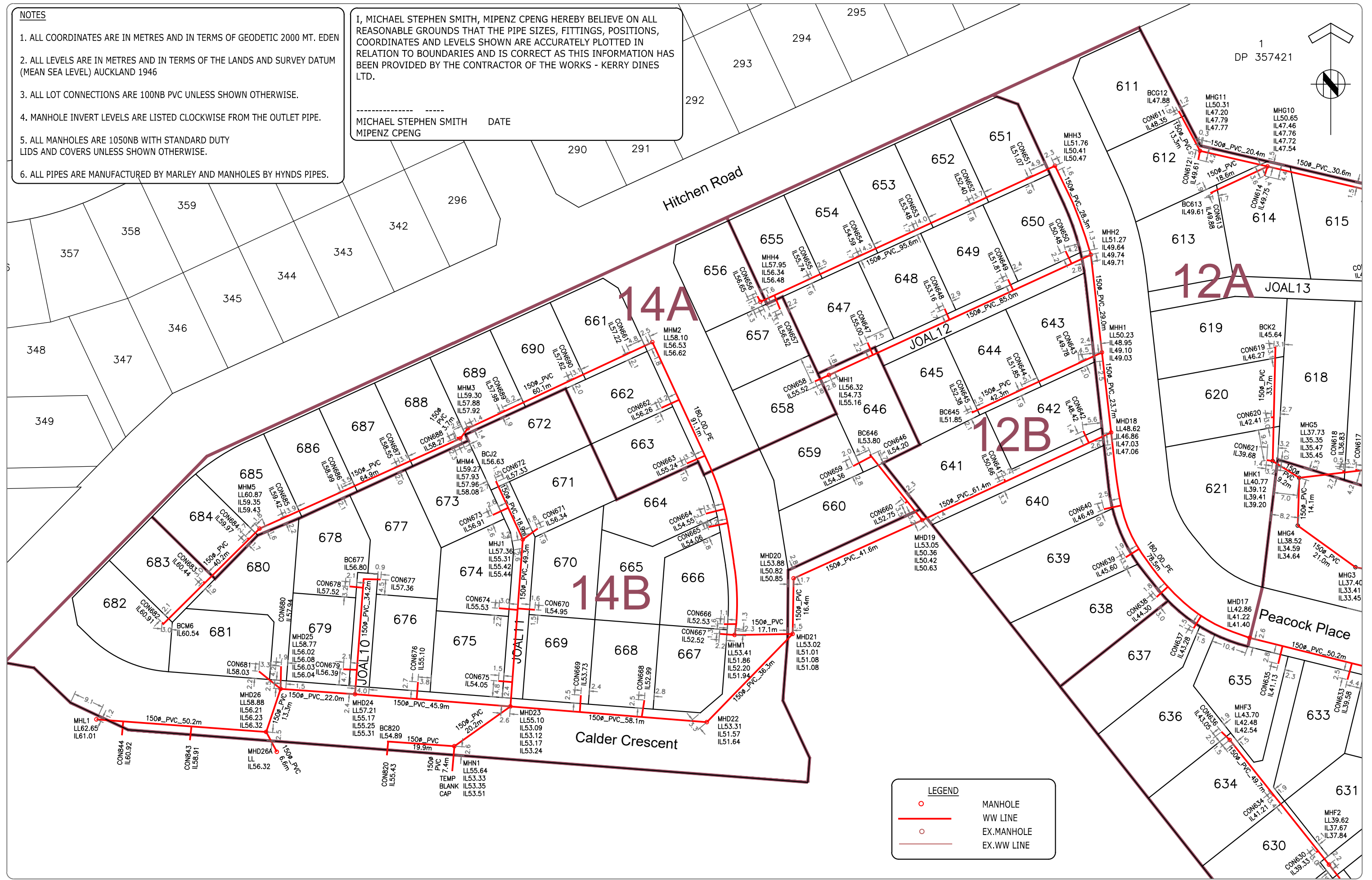

ISSUED FOR 224C	RJP	02-20
REVISION DETAILS	BY	DATE

PLOTTED:	DATE:	02-20
DRAWN:	DATE:	02-20
APPROVED:	DATE:	02-20

THIS DRAWING AND DESIGN REMAINS THE PROPERTY OF, AND MAY NOT BE REPRODUCED OR ALTERED, WITHOUT THE WRITTEN PERMISSION OF CIVILPLAN CONSULTANTS LIMITED. NO LIABILITY SHALL BE ACCEPTED FOR UNAUTHORISED USE OF THIS DRAWING.

**CIVILPLAN**  
CONSULTANTS

Level 3 AMI Building, 15 Osterley Way, Manukau City. Phone: 2222445

PROJECT TITLE:  
**DFH JOINT VENTURE  
 HITCHEN STAGES 11,12,14 SUBDIVISION  
 POKENO**

SHEET TITLE:  
**AS BUILT  
 WASTE WATER DRAINAGE  
 SHEET 1**

ISSUE STATUS:  
**AS BUILT**

SCALE: (A1/A3)  
 1:500 / 1:1000

DRAWING NUMBER: **136701-11-AB402** REV: **A**

Filepath: P:\APPDATA\LOCAL\AUTODESK\C3D 2020\ENU\TEMPLATE C:\DATA\POKENO\HITCHEN\STAGE 11\AS BUILT\136701-11-AB402.DWG

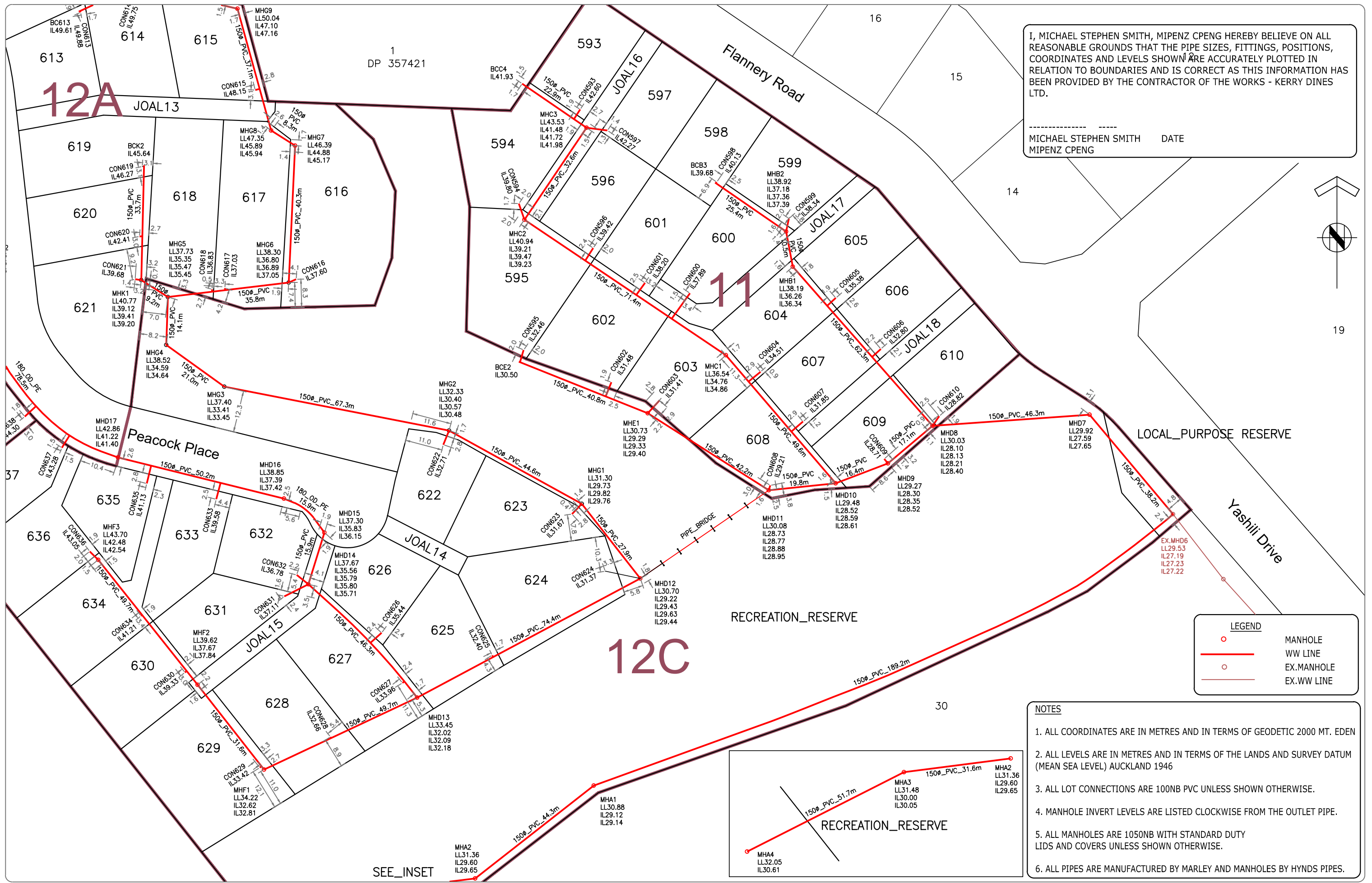

I, MICHAEL STEPHEN SMITH, MIPENZ CPENG HEREBY BELIEVE ON ALL REASONABLE GROUNDS THAT THE PIPE SIZES, FITTINGS, POSITIONS, COORDINATES AND LEVELS SHOWN ARE ACCURATELY PLOTTED IN RELATION TO BOUNDARIES AND IS CORRECT AS THIS INFORMATION HAS BEEN PROVIDED BY THE CONTRACTOR OF THE WORKS - KERRY DINES LTD.

----- DATE  
 MICHAEL STEPHEN SMITH  
 MIPENZ CPENG

**LEGEND**

- MANHOLE
- WW LINE
- EX.MANHOLE
- EX.WW LINE

- NOTES**
1. ALL COORDINATES ARE IN METRES AND IN TERMS OF GEODETIC 2000 MT. EDEN
  2. ALL LEVELS ARE IN METRES AND IN TERMS OF THE LANDS AND SURVEY DATUM (MEAN SEA LEVEL) AUCKLAND 1946
  3. ALL LOT CONNECTIONS ARE 100NB PVC UNLESS SHOWN OTHERWISE.
  4. MANHOLE INVERT LEVELS ARE LISTED CLOCKWISE FROM THE OUTLET PIPE.
  5. ALL MANHOLES ARE 1050NB WITH STANDARD DUTY LIDS AND COVERS UNLESS SHOWN OTHERWISE.
  6. ALL PIPES ARE MANUFACTURED BY MARLEY AND MANHOLES BY HYNDS PIPES.

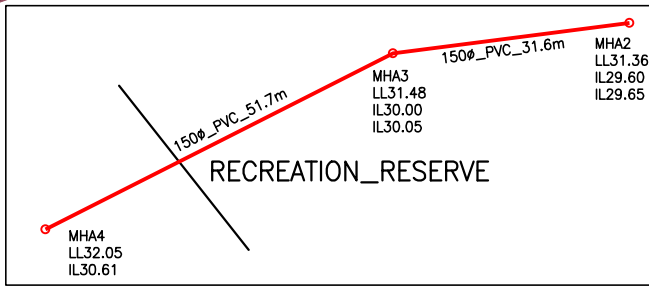

ISSUED FOR 224C	RJP	02-20
REVISION DETAILS	BY	DATE

DATE: 02-20	THIS DRAWING AND DESIGN REMAINS THE PROPERTY OF, AND MAY NOT BE REPRODUCED OR ALTERED, WITHOUT THE WRITTEN PERMISSION OF CIVILPLAN CONSULTANTS LIMITED. NO LIABILITY SHALL BE ACCEPTED FOR UNAUTHORISED USE OF THIS DRAWING.
DATE: 02-20	
DATE: 02-20	
DATE: 02-20	

**CIVILPLAN CONSULTANTS**

Level 3 AMI Building, 15 Osterley Way, Manukau City. Phone: 2222445

PROJECT TITLE:  
**DFH JOINT VENTURE  
 HITCHEN STAGES 11,12,14 SUBDIVISION  
 POKENO**

SHEET TITLE:  
**AS BUILT  
 WASTE WATER DRAINAGE  
 SHEET 1**

ISSUE STATUS: **AS BUILT**

SCALE: (A1/A3)  
 1:500 / 1:1000

DRAWING NUMBER: **136701-11-AB403** REV: **A**

Filepath: P:\APPDATA\LOCAL\AUTODESK\C3D 2020\ENU\TEMPLATE C:\DATA\POKENO\HITCHEN\STAGE 11\AS BUILT\136701-11-AB402.DWG

WASTEWATER COORDINATES  
MH=MANHOLE, BC=BLANK CAP

MHA1	758729.43	422104.31
MHA2	758702.14	422069.42
MHA3	758698.11	422038.02
MHA4	758674.76	421991.87
MHB1	758882.10	422162.87
MHB2	758892.43	422160.92
BCB3	758906.84	422139.99
MHC1	758856.05	422143.18
MHC2	758895.95	422083.90
MHC3	758923.00	422102.20
BCC4	758935.96	422083.26
MHD7	758838.59	422250.17
MHD8	758835.28	422203.99
MHD9	758824.23	422190.86
MHD10	758818.36	422175.49
MHD11	758816.33	422155.81
MHD12	758790.37	422118.00
MHD13	758755.33	422052.35
MHD14	758788.68	422020.35
MHD15	758803.90	422025.08
MHD16	758813.89	422013.17
MHD17	758825.99	421964.37
MHD18	758886.54	421923.53
MHD19	758860.71	421867.75
MHD20	758843.57	421829.83
MHD21	758827.13	421829.54
MHD22	758801.13	421804.18
MHD23	758805.78	421746.24
MHD24	758809.36	421700.41
MHD25	758810.94	421678.42
MHD26	758798.27	421674.17
MHD26A	758792.39	421677.33
MHE1	758838.98	422120.20
BCE2	758854.14	422082.27
MHF1	758734.15	422007.29
MHF2	758759.12	421987.77
MHF3	758795.88	421958.51
MHG1	758812.36	422100.81
MHG2	758833.91	422061.74
MHG3	758846.82	421995.62
MHG4	758859.10	421978.56
MHG5	758873.20	421979.00
MHG6	758877.43	422014.57
MHG7	758917.72	422016.42
MHG8	758922.17	422009.40
MHG9	758958.01	421999.47
MHG10	758965.01	421969.66
MHG11	758969.61	421949.73
MHG12	758981.37	421943.42
MHH1	758910.16	421920.78
MHH2	758938.99	421917.54
MHH3	758965.19	421906.92
MHH4	758925.15	421820.01
MHI1	758903.49	421840.26
MHI1	758855.03	421749.89
BCJ2	758872.23	421741.96
MHK1	758878.15	421971.18
BCK2	758911.93	421972.01

WASTEWATER COORDINATES  
MH=MANHOLE, BC=BLANK CAP

MHL1	758801.96	421624.11
MHM1	758826.84	421812.42
MHM2	758913.20	421788.15
MHM3	758887.80	421733.68
MHM4	758884.80	421731.47
MHM5	758858.22	421672.24
BCM6	758829.89	421643.65
MHN1	758794.06	421729.72
BC645	758892.42	421882.39
BC613	758957.16	421952.80
BC646	758880.11	421852.26
BC677	758843.55	421702.93

WASTEWATER COORDINATES  
CON=CONNECTION

CON593	758928.40	422100.31
CON594	758900.67	422082.28
CON595	758857.60	422083.68
CON596	758887.58	422104.15
CON597	758922.18	422108.33
CON598	758907.03	422140.49
CON599	758896.29	422161.73
CON600	758874.31	422132.62
CON601	758877.37	422119.38
CON602	758848.14	422109.48
CON603	758842.75	422123.63
CON604	758851.18	422153.37
CON605	758872.93	422175.54
CON606	758857.90	422188.76
CON607	758836.55	422165.88
CON608	758817.78	422156.24
CON609	758825.56	422189.77
CON610	758838.15	422205.95
CON611	758980.88	421943.38
CON612	758967.00	421949.20
CON613	758956.94	421953.32
CON614	758962.23	421968.74
CON615	758934.10	422004.71
CON616	758878.41	422016.76
CON617	758875.83	421995.78
CON618	758875.45	421992.01
CON619	758911.56	421971.49
CON620	758891.01	421970.67
CON621	758878.41	421969.41
CON622	758829.72	422060.05
CON623	758809.33	422097.91
CON624	758792.53	422107.66
CON625	758767.79	422074.43
CON626	758774.38	422041.89
CON627	758759.65	422048.01
CON628	758743.77	422026.82
CON629	758734.71	422006.06
CON630	758762.73	421984.03
CON631	758785.10	422013.25
CON632	758791.43	422016.92
CON633	758813.69	421993.24

WASTEWATER COORDINATES  
CON=CONNECTION

CON634	758779.36	421971.11
CON635	758818.33	421972.80
CON636	758798.33	421956.03
CON637	758828.82	421947.83
CON638	758838.02	421936.91
CON639	758849.75	421927.80
CON640	758863.93	421921.36
CON641	758872.83	421891.92
CON642	758887.02	421915.25
CON643	758907.49	421914.05
CON644	758899.73	421897.47
CON645	758892.93	421882.51
CON646	758880.03	421852.72
CON647	758913.12	421851.64
CON648	758923.07	421874.37
CON649	758931.76	421893.06
CON650	758940.08	421910.06
CON651	758962.47	421900.22
CON652	758954.59	421883.21
CON653	758946.85	421866.65
CON654	758939.26	421850.02
CON655	758932.42	421835.27
CON656	758926.80	421819.12
CON657	758922.86	421825.83
CON658	758901.63	421836.07
CON659	758876.63	421847.36
CON660	758865.71	421862.71
CON661	758910.43	421781.37
CON662	758893.81	421790.79
CON663	758877.40	421798.30
CON664	758862.63	421803.88
CON665	758858.66	421804.72
CON666	758830.04	421809.22
CON667	758827.20	421807.92
CON668	758807.65	421785.77
CON669	758809.10	421767.01
CON670	758834.29	421753.45
CON671	758858.23	421754.33
CON672	758872.08	421742.35
CON673	758862.23	421741.00
CON674	758834.73	421742.86
CON675	758813.27	421742.69
CON676	758813.00	421718.95
CON677	758843.22	421707.97
CON678	758841.15	421698.73
CON679	758816.75	421696.89
CON680	758817.63	421678.57
CON681	758816.14	421672.00
CON682	758830.55	421643.43
CON683	758842.62	421655.60
CON684	758855.49	421668.61
CON685	758862.17	421680.22
CON686	758869.63	421696.99
CON687	758877.15	421713.82
CON688	758885.06	421730.34
CON689	758893.20	421744.28
CON690	758902.66	421764.75

STORMWATER COORDINATES  
MH=MANHOLE, BC=BLANK CAP

MH1.0	758836.59	422237.11
MH1.1	758829.76	422211.40
MH1.2	758818.45	422179.53
MH1.3	758808.27	422159.59
MH1.4	758787.18	422125.54
MH1.5	758789.80	422113.25
MH1.6	758770.12	422076.72
MH1.7	758794.17	422064.63
MH1.8	758804.68	422044.23
MH1.9	758799.43	422025.45
MH1.10	758808.50	422018.13
MH1.11	758823.96	421954.48
MH1.12	758837.12	421938.14
MH1.13	758848.42	421929.12
MH1.14	758861.79	421922.17
MH1.15	758844.16	421884.42
MH1.16	758863.31	421869.44
MH1.17	758843.15	421825.75
MH1.18	758825.28	421825.44
MH1.19	758805.35	421802.21
MH1.20	758810.03	421742.27
MH1.21	758813.12	421702.25
MH1.22	758815.20	421677.01
MH1.23	758818.94	421627.73
MH2.1	758884.15	422164.95
MH2.2	758894.81	422163.08
BC2.3	758908.62	422142.67
MH3.1	758829.28	422170.14
MH3.2	758858.13	422144.78
MH3.3	758898.55	422086.88
MH3.4	758925.22	422104.61
BC3.5	758938.71	422084.56
MH4.1	758755.99	422050.45
BC4.2	758735.97	422006.93
MH5.1	758783.15	422020.11
MH5.2	758759.77	421990.90
MH5.3	758799.88	421958.97
MH6.1	758824.24	422042.51
MH6.2	758835.98	421994.33
MH6.3	758851.79	421972.32
MH6.4	758879.36	421973.80
MH6.5	758924.45	421976.91
MH6.6	758933.29	421983.71
MH6.7	758961.32	421978.49
MH6.8	758968.67	421947.85
BC6.9	758980.32	421941.72
OUT7.0	758929.38	422029.82
MH7.1	758928.94	422027.40
MH8.1	758905.10	421917.44
MH8.2	758935.48	421913.73
MH8.3	758960.66	421904.76
MH8.4	758978.58	421896.65
MH9.1	758937.08	421853.14
MH10.1	758847.25	421808.17
MH10.2	758866.84	421805.03
MH10.3	758908.42	421785.77
MH10.4	758926.47	421777.49
MH11.1	758854.32	421745.74
MH11.2	758881.99	421732.99

STORMWATER COORDINATES  
MH=MANHOLE, BC=BLANK CAP

MH11.3	758854.10	421671.06
BC11.4	758839.73	421657.52
OUT12.0	758854.23	421863.84
MH12.1	758863.90	421863.31
MH12.2	758882.57	421848.32
MH12.3	758925.56	421828.57
BC12.4	758921.48	421818.82
MH13.1	758910.27	421859.08
MH14.1	758862.63	422221.93
OUT602	758852.37	422083.12
OUT603	758939.55	422115.45
OUT622	758831.63	422073.28
OUT617	758868.32	422011.16
BC613	758934.12	421957.67
BC641	758889.04	421882.46
BC672	758892.08	421749.81
BC677	758840.96	421704.29
CP1	758986.62	421908.80
CP2	758983.21	421901.70
CP3	758933.68	421912.77
CP4	758930.69	421978.30
DCP5	758929.49	422009.33
CP6	758911.77	421931.26
CP7	758910.84	421923.41
CP8	758839.88	421957.48
CP9	758833.13	421953.29
DCP10	758816.01	422039.29
CP12	758798.37	422026.37
DCP13	758897.04	422087.89
DCP14	758868.15	422142.63
DCP15	758830.67	422168.17
CP16	758934.52	421789.86
CP17	758931.34	421782.58
CP18	758869.52	421818.68
CP19	758868.71	421810.74
DCP20	758804.50	421820.88
DCP21	758806.68	421813.25
CP22	758808.48	421748.44
CP23	758795.74	421739.63
CP24	758803.65	421739.84
CP25	758812.08	421703.22
CP27	758809.03	421670.18
CP28	758801.12	421669.60
CP29	758826.43	421614.73
CP30	758820.99	421608.84
CP31	758866.82	422226.71
CP32	758880.30	422226.01

STORMWATER COORDINATES  
CON=LOT CONNECTION

CON593	758929.10	422099.75
CON594	758902.87	422084.40
CON595	758857.77	422084.64
CON596	758886.68	422104.52
CON597	758922.86	422108.45
CON598	758908.90	422143.34
CON599	758895.54	422163.66
CON600	758873.06	4